

# Chronothermostat for radiator

## Art. 140



100% MADE IN ITALY 

**Function** Radiator chronothermostat with weekly programming and installation on thermostatic valves for the room temperature regulation.

These devices art.140 can independently maintain the present comfort temperatures according to predefined daily/weekly programs or freely programmable by the user. The shutter acts on the valve, determining its opening, even partial, according to the difference between the set temperature and the detected one.

Classification according to point 6 of the Communication 2014 / C 207/02 of the European Commission: class IV.

Available in standard or radiofrequency version to control more heads at the same time by way of the wall-mounted chronothermostat art. 9051.

The connection is **suited with every Pintossi thermostatic valve** thanks to the specific included adaptor, and also with all thermostatic valves with 30 x1,5 thread.

### Technical specifications

Operation:	Automatic and manual
Power supply:	2 batteries 1,5 V (type AA)
Operating temperature:	0 ÷ 50 °C
Protection degree:	IP 30

## Installation

The chronothermostat can be installed on any type of Pintossi+C thermostatic valve thanks to the use of the included adaptor, without interrupting the heating circuit.

Follow the below steps to install the device:

1. Unscrew the protection cap of the thermostatic valve;
2. Insert the adaptor into the coupling ring;
3. Screw the coupling ring complete with the adaptor on the thread of Pintossi+C thermostatic valve;
4. Insert the chronothermostat on the coupling ring as long as you hear the click that confirm the successful connection;
5. In case of thermostatic valves with 30x1,5 thread the coupling ring can be screwed directly on the valve without using Pintossi+C adaptor.

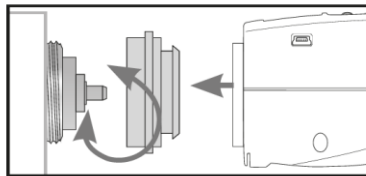

Valve – Coupling ring

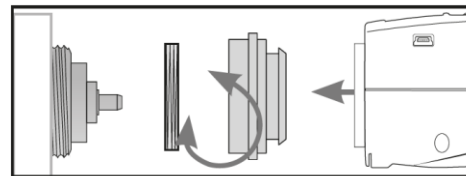

Valve – Adaptor - Coupling ring

Warning: do not apply overexertion when fixing the chronothermostat on the coupling ring.

Make sure that the chronothermostat is in INST position during the installation.

## Matching to the valve

Press the MENU button and scroll with the wheel until the sign ADAP appears on the display. Press OK: the chronothermostat will be able to start adapting to the valve. This can take a few minutes. After the successful adaptation, the device returns to normal mode.

-> If a new adaptation is necessary, repeat the procedure.

-> If error message E2 appears, remove the batteries for a short time in order to reset the device.

## Removal

To remove the chronothermostat set the menu to ON (MENU --> TEMP --> ON) and wait a brief time.

Then press the quick release button on the device and pull the chronothermostat out of the matching/coupling ring.

